

Eagle Pneumatic T-110 Drive-Thru System



Eagle Pneumatic's T-110 Drive Thru System is a dependable Overhead vacuum-vacuum pneumatic tube system providing a secure easy way to transfer cash, paperwork or prescriptions.

Manufactured for versatility the T-110 is available in 4.5" steel or PVC tubing. The system can also be built to accommodate 4" steel tubing. The T-110 has a slim design allowing for installation into a variety of narrow islands.

The slide gate eliminates the need for external doors at both the Customer and Teller stations. Installation of remote blowers above each station create a quiet operating system and smooth delivery of the carrier.

Standard features of the unit include a stainless steel construction with a powder coated top and pedestal. The front panel has a key lock allowing for easy access to the interior of the unit. This Drive-Thru System is ideal for new installation or replacement of existing systems.

The T-110 comes equipped with a 7" video display window. There are multiple communication options for the unit including audio only and 1 or 2 way video.

Eagle Pneumatic, Inc.

The World's Most Versatile Pneumatic Tube Delivery Systems



Eagle Pneumatic T-110 Drive-Thru System

Drive-Up Customer Stations

DIMENSIONS

System Size	4 1/2"
A	21 1/2"
B	43 3/8"
C	2"
D	8 1/2"
E	6 1/8"
F	4 1/2"
G	17 1/2"
H	3 3/8"
J	7 5/16"
I	11 3/4"

Optional T-110 products:

Truck Bases 7", 10" and 12"
 Defrosting Unit 30 or 80 Watt
 Overhead Installations Only
 4.5" PVC or Steel
 4" Steel
 7" LCD Display
 Audio

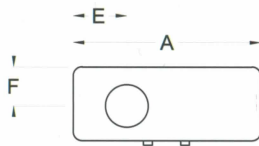

ELECTRICAL REQUIREMENTS

Power: 115V, single-phase, 60 Hz

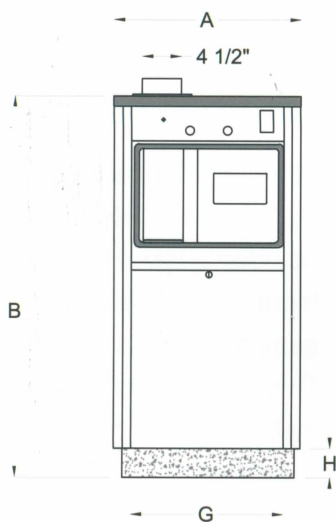

FRONT ELEVATION
T-110A

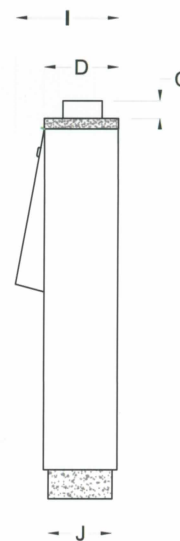

SIDE VIEW



Eagle Pneumatic, Inc.
 3902 Industry Boulevard
 Lakeland, Florida 33811
 Tel: 863.644.4870
 Tel: 800.237.8261
 Fax: 863.647.5328

E-mail: sales@eaglepneumatic.com
www.eaglepneumatic.com